

	Detalj	Art. nr.
1	Mounting plate	FP0300
2	Mounting bracket	FJ3030
3	Smooth mounting plate	FP1030
4	Universal fastening profile	IP5000
5	Carriage bolt M10x30	VB1301/VB1305
6	Bracket type 5	NS5000

	Detalj	Art. nr.
7	Roof ladder spacer	DS5700
8	Wood screw hex head 6x30	TS0630
9	Wood screw countersunk 6x35	TS0635
10	Flange nut M10	MU1001/MU1010
11	Rubber seal	GL5000

Follow the Swedish Work Environment Authority's regulations! All work at heights over 2 meters must be performed using fall protection equipment. Weland Stål can help you create a safe workplace.

Ladder on tile roof

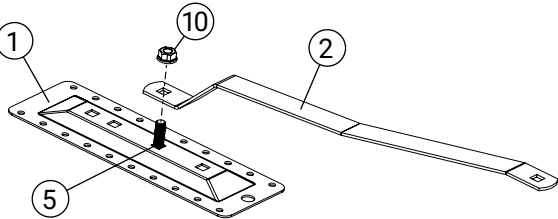

1. Mounting the bracket

Attach the bracket (2) to the mounting plate (1) using carriage bolts (5) and nuts (10).

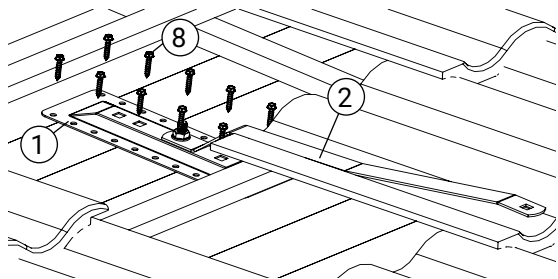

2. Adjust to the roof tile

Adjust the mounting plate (1) and bracket (2) to fit the valley of the roof tile and fasten using 10 pcs of 6x30 wood screws (8).

Note: Use a screwdriver with torque control to prevent the screws from stripping and losing grip.

Installation on flat roof

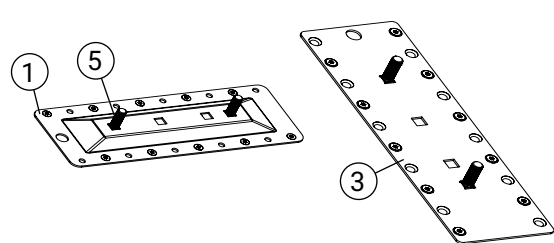

1. Mounting the plate

Insert carriage bolts (5) into the mounting plate (1), fasten using 10 pcs of 6x35 wood screws (9). Horizontal installation for spacer, vertical installation for bracket type 5.

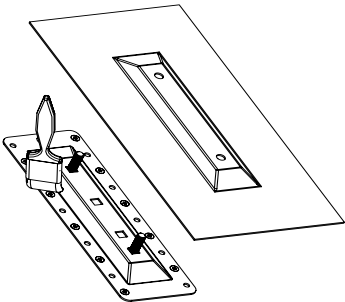

2. Gluing the protective patch

Cut a protective patch at least 50 mm larger than the base plate on all sides, glue the patch to the surface.

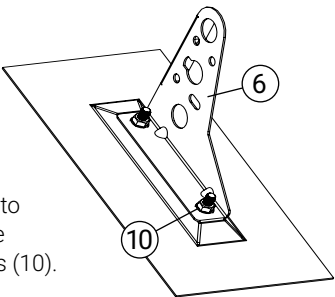

3. Mounting

Attach bracket (6) to the mounting plate using 2 pcs of nuts (10).

	Detalj	Art. nr.
1	Mounting plate	FP0300
2	Mounting bracket	FJ3030
3	Smooth mounting plate	FP1030
4	Universal fastening profile	IP5000
5	Carriage bolt M10x30	VB1301/VB1305
6	Bracket type 5	NS5000

	Detalj	Art. nr.
7	Roof ladder spacer	DS5700
8	Wood screw hex head 6x30	TS0630
9	Wood screw countersunk 6x35	TS0635
10	Flange nut M10	MU1001/MU1010
11	Rubber seal	GL5000

Follow the Swedish Work Environment Authority's regulations! All work at heights over 2 meters must be performed using fall protection equipment. Weland Stål can help you create a safe workplace.

Mounting on sloped roof

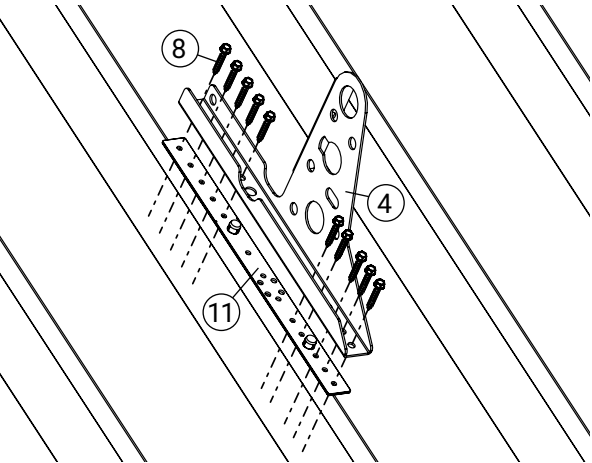

1. Mounting the bracket

Install bracket (4) with rubber seal.

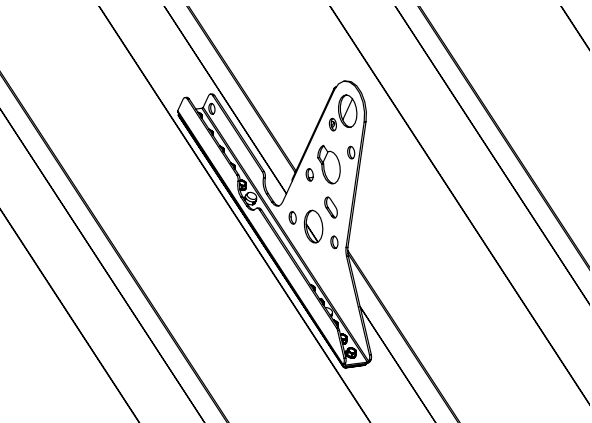

2. Mounting the bracket

Screw it in place using 10 pcs of 6x30 wood screws (8).

Note: Use a screwdriver with torque control to prevent the screws from stripping and losing grip.

Installation on flat roof

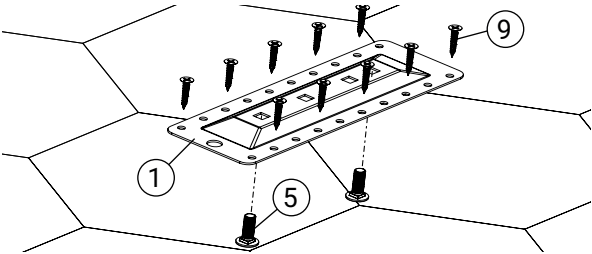

1. Mounting the plate

Install the mounting plate with carriage bolts, fasten using 10 pcs of 6x35 wood screws.

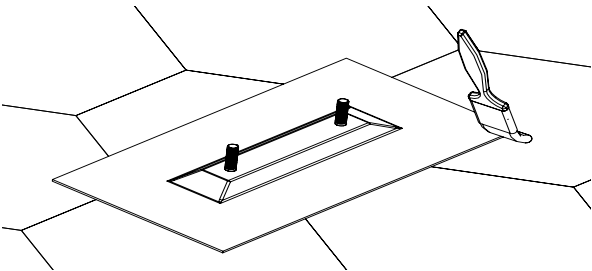

2. Gluing the protective patch

Cut a protective patch and glue it to the surface.

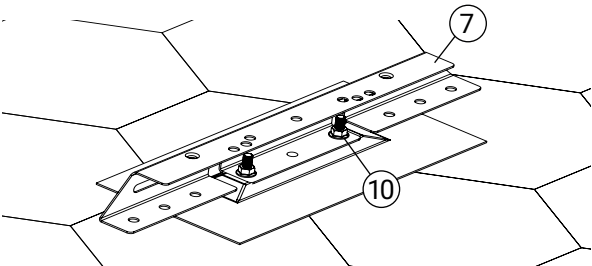

3. Mounting

Attach spacer (7) to the mounting plate using 2 pcs of nuts (10).