

	Part	Part. no.
1	Fixing profile	IP33XX
2	Attachment plate, universal	TP1217/TP1722
3	Self-tapping screw 6.3x19	SS6191/SS6190
4	Flange nut M10	MU1001/MU1010
5	Bolt M10x20	BU1201/BU1200

	Part	Part. no.
6	Coach bolt M10x30	VB1301/VB1305
7	Bolt kit for attachment plate	BS0010
8	Mount type 5	NS5000
9	Self-drilling screw 5.5x22	SS5221/SS5225
10	Rubber washer Ø50 M10	GB5010 (GB0010)

Max. distance between the brackets 1200 mm – Min. plate thickness 0.5 mm.

Fixing profile

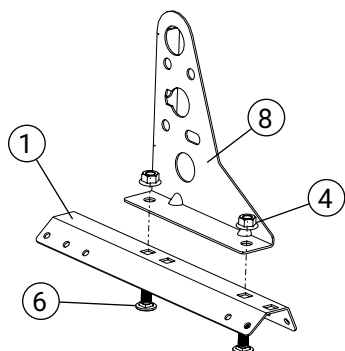

1. Installation bracket

Install the bracket (9) for the fixing profile (1) using 2 coach bolts (6) M10x30 + nuts (4).

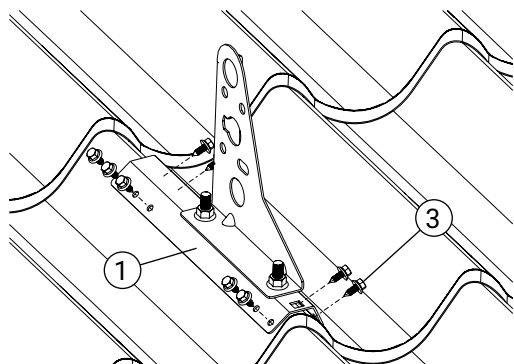

2. Installation

Screw the fixing profile (1) to the spine of the roof plate using 10 6.3x19 self-tapping screws (3). If the plate is 0.7 mm or thicker, 5.5x22 mm self-tapping screws (9) may be used.

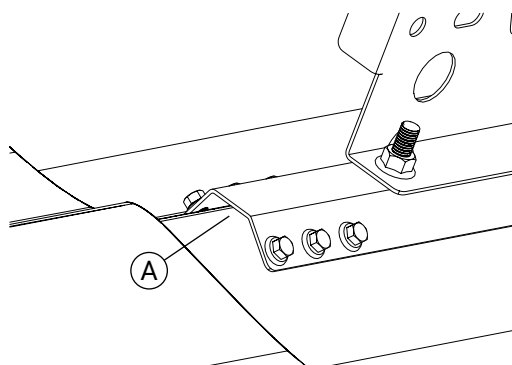

3. Seal

The air pocket at the top, between plate and profile (A), should be filled with sealing compound.

Fixing plate

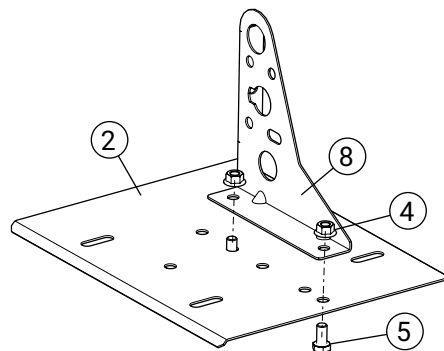

1. Installation bracket

Fit bracket (9) to the fixing plate (2) using 2 M10x20 (5) bolts + nuts (4).

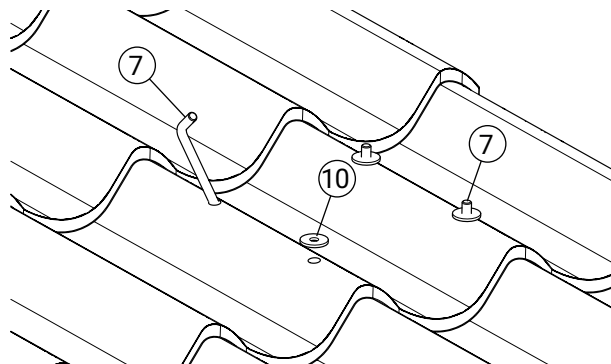

2. U-bolts

Drill holes for the U-bolts (7) and pass through the holes and fit on rubber washers (10).

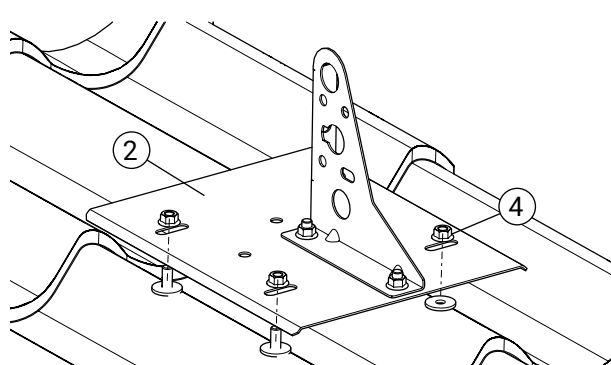

3. Installation

Then, fit the fixing plate (2) using 4 nuts (4).