

	Part	Part. no.
1	End bracket wire	WL1002
2	Wire runner open	WL1010
3	Wire bracket tube	WL1012
4	Wire joining tube	XWL1006
5	Wire clamping sleeve	XWL1014

	Part	Part. no.
6	Wire	XWLXXXX
7	Nut M10	MU1001/MU1010
8	U-fitting	XBY0850
9	Nut MB	MU0801/ MU0805

The maximum separation between supports is 10 m up to 15 degrees pitch.

Between 15-50 degrees gradient, the max. separation is 2.5m.

Above 50 degrees gradient, the max. separation is 1.2 m.

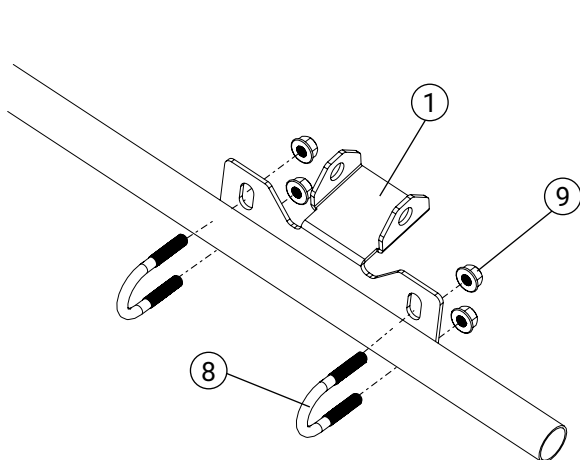

1 Bracket

Install end bracket (1) using 2 U-fittings + nuts (8,9).

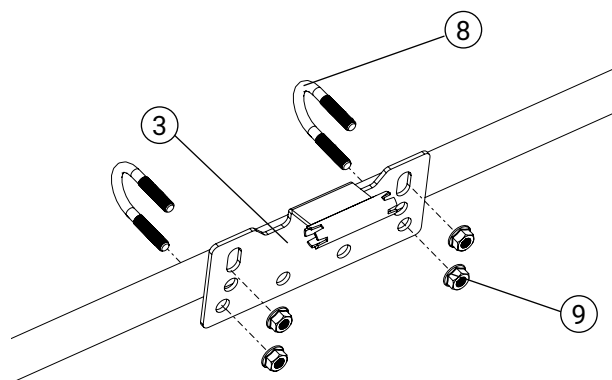

2. Support tube

Install wire support tube (6) using 2 U-fittings + nuts (8,9).

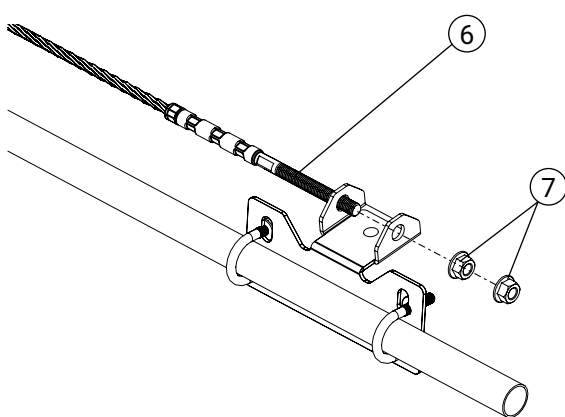

3. Wire installation

Install the first wire terminal (6). Assemble with 2 nuts (7) **Secure by tightening the other nut (7).** Route the wire through any support.

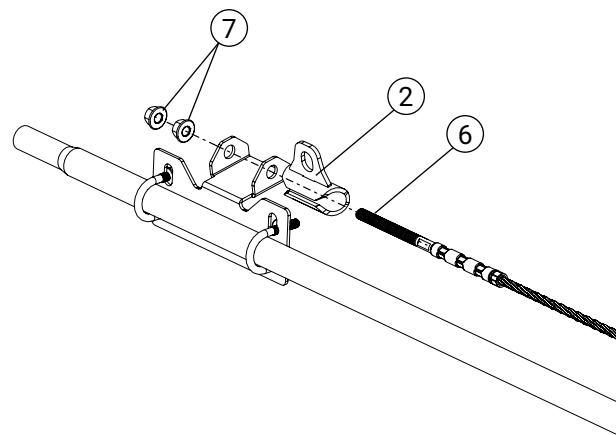

4. Wire installation

Install the last wire terminal (6). Thread on any wire runner (2). Tension the wire so it does not sag. **Secure by tightening the other nut (7).**

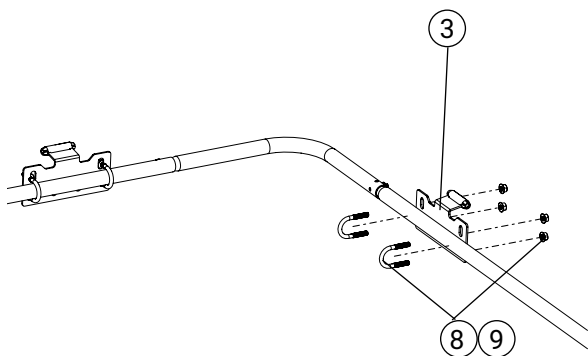
**5 Wire corner**

Install wire bracket tube (3) using 2 U-fittings + nuts (8, 9). Make a uniform hoop of the wire, so the runner runs freely.

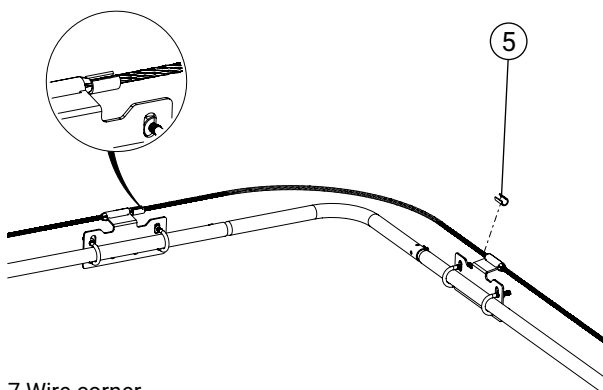
**7 Wire corner**

The sleeves (5) are pressed against the bracket, so the wire keeps its shape. Make the pinch using a press or with large tongs.

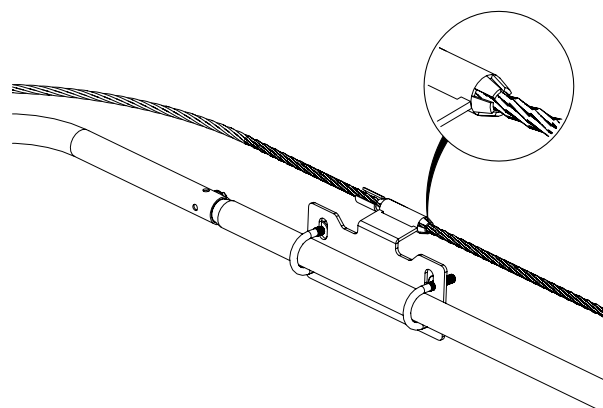
**6. Shrinking**

Shrink the ends on wire bracket tube using tongs to attach the wire.

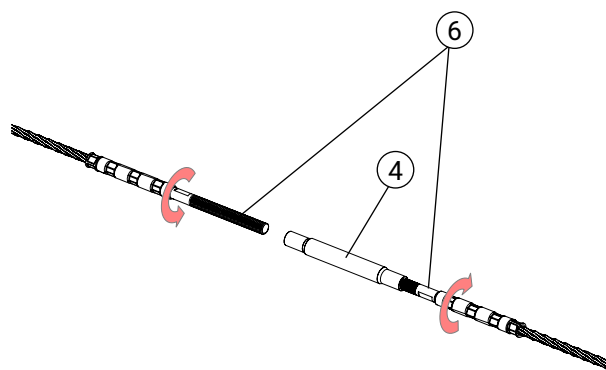
**8. Wire joint**

Screw in the terminals (6) to the centre, so they meet in the butt connector (4). Tighten so the terminals lock against each other.