

Wire system – WeLine on roof/cat ladder

	Part	Part. no.
1	ONE wire bracket	WL1337
2	End bracket wire	WL1002
3	Wire runner open	WL1005
4	Wire bracket tube	WL1012
5	Right/left fall stop	BS1301(L)/BS1302(R)
6	8 mm wire	XWL1008

	Part	Part. no.
7	Bolt M10x20	BU1201/BU1200
8	Bolt M10x60	BU1601
9	Coach bolt M10x30	VB1301/VB1305
10	Flange nut M10	MU1001/MU1010
11	Wire clamping sleeve	XWL1014

Recommended distances between supports/mounts:

10 m up to 15 degrees pitch, 2.5 m between 15-50 degrees pitch, and 0.9 m over 50 degrees pitch.

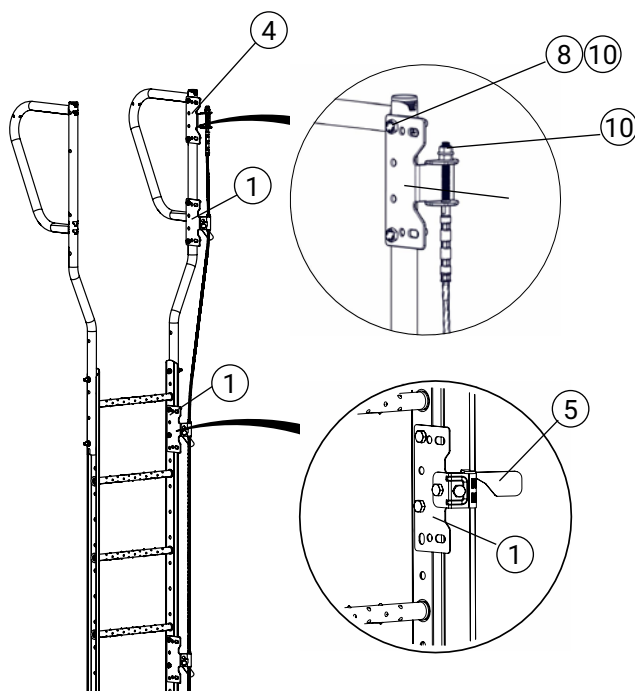

1. Wire installation

Fit upper end bracket wire (2) on the handrail using 2 bolts + nuts (8,10).

Secure by tightening the other nut (10). If the ladder does not have a handrail, the last end bracket wire (2) is to be located as far up the ladder as possible.

Fit fall stop (5) on handrail using 2 bolts + nuts (8, 10). Route the wire through the fall stop.

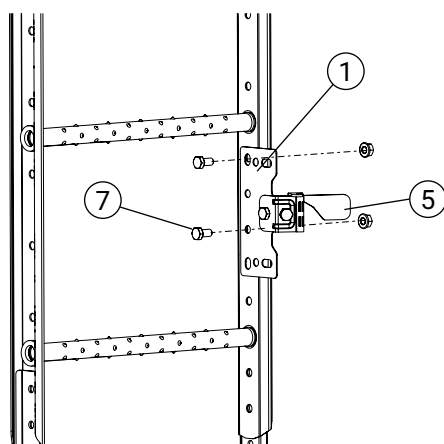

2. Fall stop

Fit fall stop (5) of c/c 900 mm to cat ladder using 2 bolts + nuts (7,10).

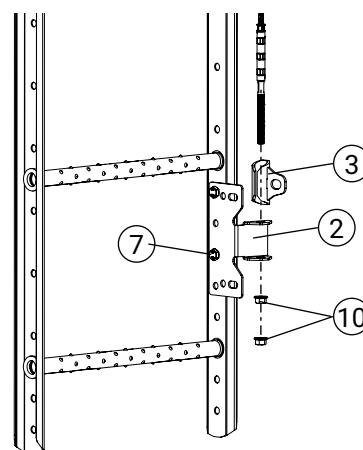

3. Wire installation

Fit lower end bracket wire (2) using 2 bolts + nuts (7, 10). Thread on any wire runner (3). Tension tension the wire so it does not sag, fit using 2 nuts (10).

Secure by tightening the other nut.

Recommended distances between supports/mounts:

10 m up to 15 degrees pitch, 2.5 m between 15-50 degrees pitch, and 0.9 m over 50 degrees pitch.

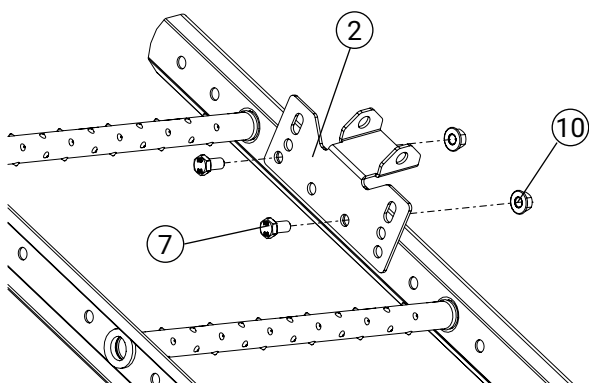
**4. End bracket**

Install end bracket (2) using 2 bolts + nuts (7, 10).

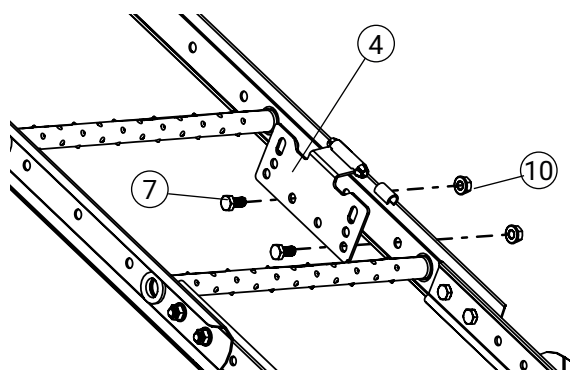
**5. Support claw**

Install bracket for wire support (4) using 2 bolts + nuts (7, 10).

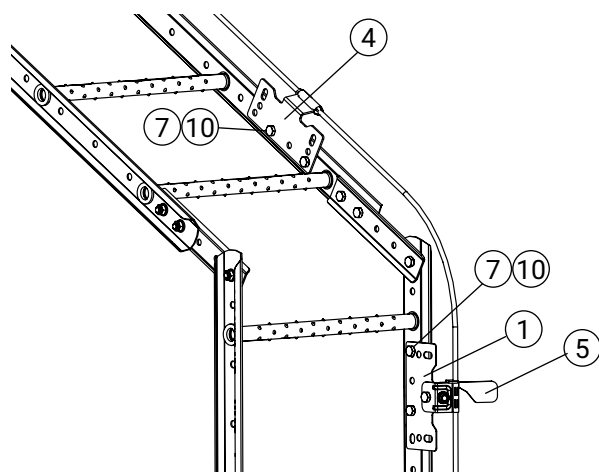
**6. Transition**

At transitions, fit the fall stop (5) on the cat ladder using 2 bolts + nuts (7,10), and tube attachment (4) on the roof ladder using 2 bolts + nuts (7,10).

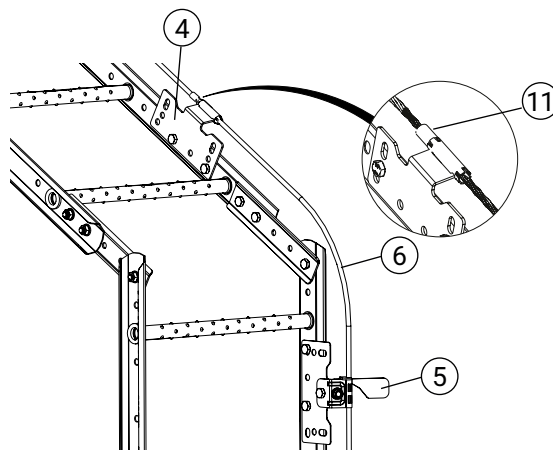
**7. Wire installation**

Make a uniform hoop of the wire (6), so the runner runs freely. Crimp the ends of the fall stop (5). Pinch the sleeves against the inside of the wire bracket (4) so that the arc on the wire holds its shape. Make the pinch using a press or with large tongs. Crimp the sleeves (11) against the inside of the bracket, so that the arc holds its shape.

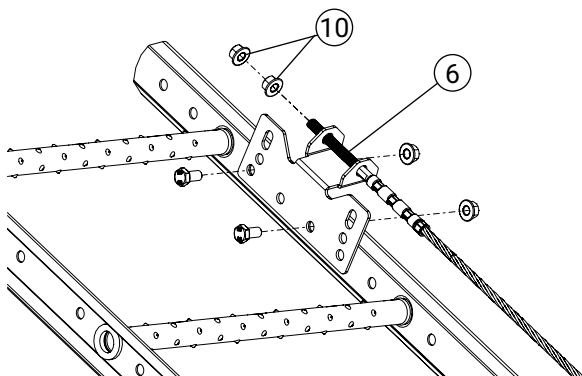
**8. Wire installation**

Fit the last wire terminal (6) using 2 nuts (10). Tension the wire so it does not sag. **Secure by tightening the other nut.**