

	Part	Part. no.
1	ONE wire bracket	WL1337
2	Bracket plain roof	WL1020
3	ONE wire lock bolt kit	BS1300
4	Bolt M10x20	BU1201/BU1200

	Part	Part. no.
5	Nut M10	MU1001/ MU1010
6	Rubber washer Ø50 M10	GB5010
7	Coach bolt M10x30	VB1301/ VB1305

Check the wire to ensure that it has the blue Weland mark and that it is not damaged.

Read more about fastenings in relevant installation instruction MA1008

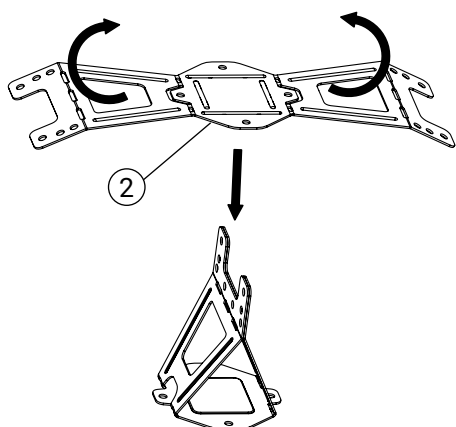

### 1. Wire bracket, plain roof

Fold the wire bracket (2) together by hand.

**NB:** only bend once. Bending this several times will damage it and must be replaced.

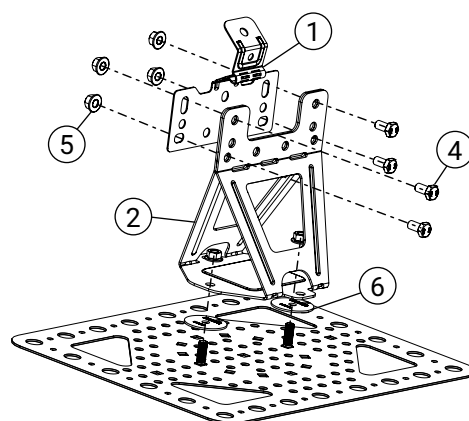

### 2. First bracket

Fit wire bracket (1) for plain roofs to the sealing plates. Attach using 2 x bolts (4), washers (6), and nuts (6) per bracket. Fit the ONE wire bracket (1) using 4 x bolts (4) + nuts (5).

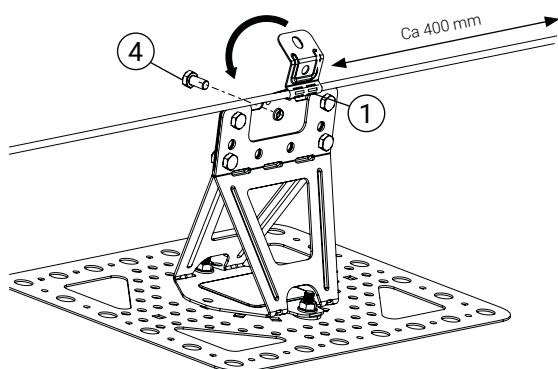

### 3. Fit ONE wire bracket as start

Place wire in a ONE wire bracket (1), let out approx. 400 mm of wire and fold the bracket together. Secure using 1 x bolt (4).

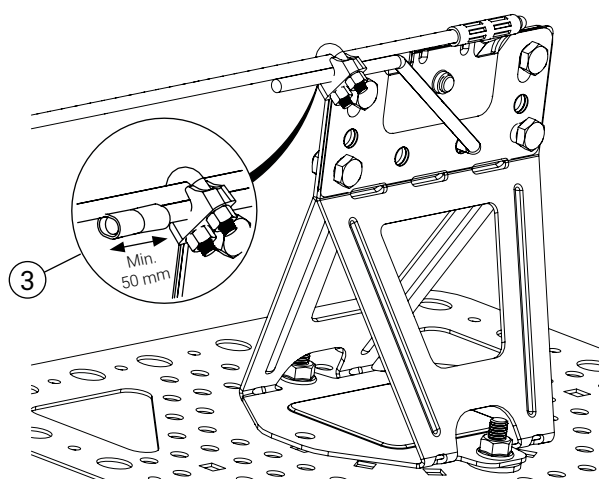

### 4. Fitting wire lock

Pull the wire backwards and through the plain roof wire bracket and ONE wire bracket (1). Thread on clamp tube (3), clamp securely in position. Fit wire lock (3) at least 50 mm from the end of the wire. Tighten the wire lock to a torque of 10 Nm.

	Part	Part. no.
1	ONE wire bracket	WL1337
2	Bracket plain roof	WL1020
3	ONE wire lock bolt kit	BS1300
4	Bolt M10x20	BU1201/BU1200

	Part	Part. no.
5	Nut M10	MU1001/ MU1010
6	Rubber washer Ø50 M10	GB5010
7	Coach bolt M10x30	VB1301/ VB1305

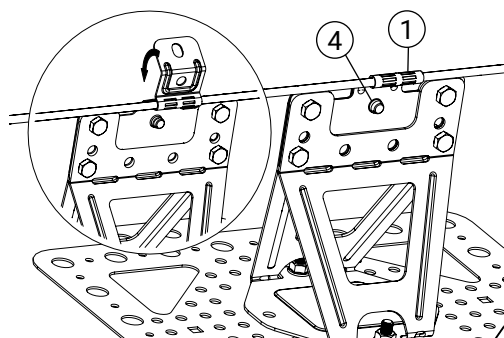

#### 5. Fit ONE wire bracket

Place wire in ONE wire bracket (1), tension the wire by pulling it by hand and fold the ONE wire bracket together. Secure using 1 x bolt (6).

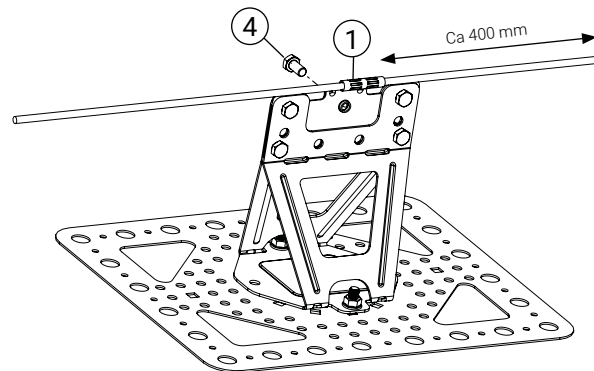

#### 6. Finish wire

Fit any wire runners. Place wire in ONE wire bracket (1), tension the wire by pulling it by hand and fold the ONE wire bracket together. Secure using 1 x bolt (6). Cut the wire approx. 400 mm from the bracket.

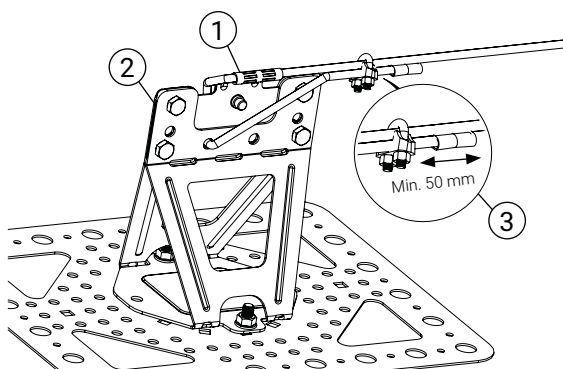

#### 7. Finish wire

Pull the wire backwards and through the plain roof wire bracket (2) and ONE wire bracket (1). Thread on clamp tube, clamp securely in position. Fit wire lock (3) at least 50 mm from the end of the wire. Tighten the wire lock to a torque of 10 Nm.

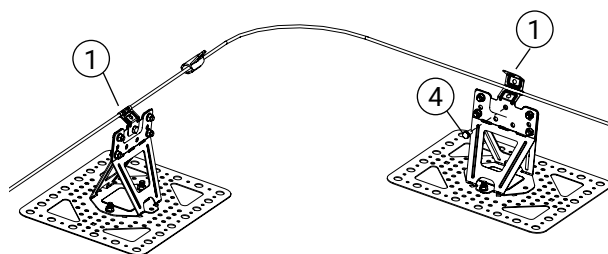

#### 8. Wire with terminal

Place the wire in one wire holder ONE (1) and lay it in an even arc so that the runner moves freely. Place the wire in the next holder and secure with bolt (4).