

	Part	Part. no.
1	Platform	PF1007/PF1507/PF2007/ PF1010/PF1510/PF2010
2	Bracket	PK0700/PK1000
3	Suspension bracket	HK0700
4	Grating	PD0705/PD0710/PD1005/ PD1010
5	Bolt M10x20	BU1201/BU1200
6	Flange nut M10	MU1001/MU1010

	Part	Part. no.
7	Lock washer for M10 nut	UL4201
8	Side bracket L	UV1001
9	Side bracket R	UV1002
10	J-hook M8x48	JK8481
11	Flange nut M8	MU0801/MU0805
12	Self-tapping screw 5.5x22	SS5221/SS5225
13	Kick strip	SL0710/SL1010/SL1510/SL2010
14	Gull wing connection	MK4200

For wall mounts, see MA1001 for dimensioning

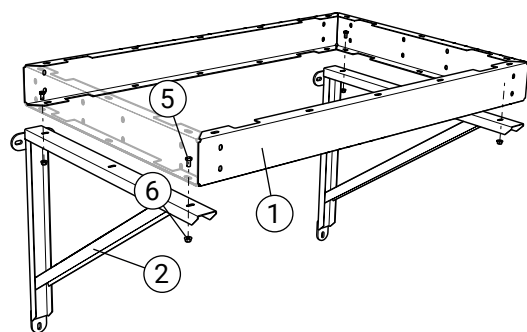

### 1a. Mounting of wall bracket

Mount the brackets (2) on the wall using 6 screw joints (NB Screw joints are NOT included. See MA1001 for grade)  
Attach the platform (1) using 4 bolts (5) + nuts (6) to the brackets.

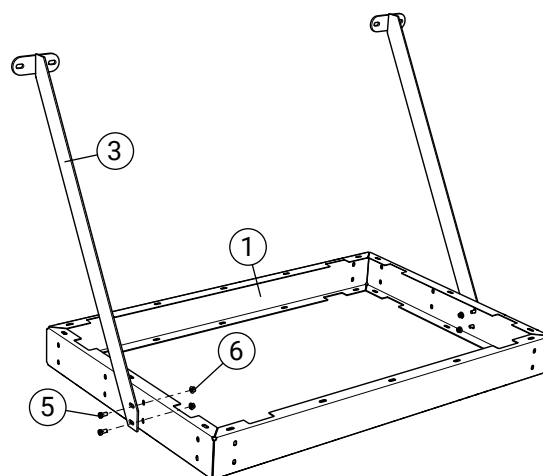

### 1b. Installation of suspension bracket

Mount the suspension brackets (3) on the wall using 4 screw joints.  
(NB Screw joints are NOT included. See MA1001 for grade)  
Fit at least 2 screw joints in the platform (1) against the wall (NB Screw joints are NOT included).  
Attach the platform (1) using 4 bolts (5) + nuts (6) to the suspension brackets.

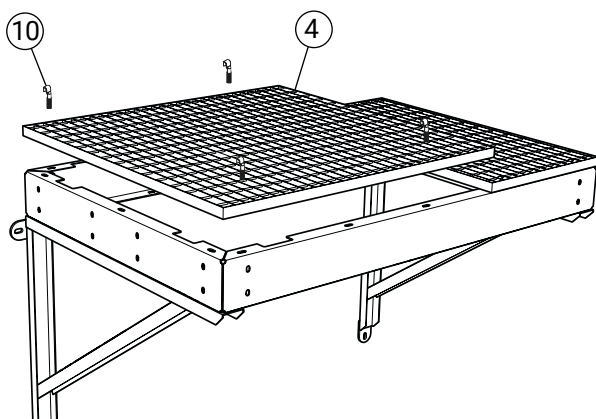

### 2. Installation of grating

Fasten the grating (4) using 4 J-hooks (10)+ nuts(11).

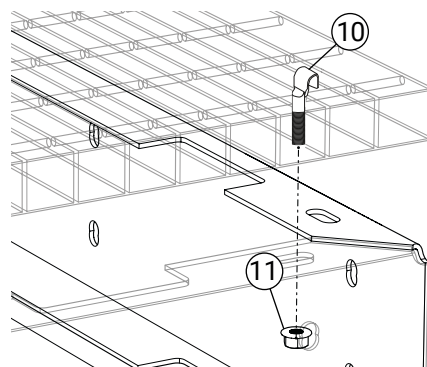

### Detail diagram, fastening using J-hook

Fasten the grating using 4 J-hooks (10)+ nuts(11).

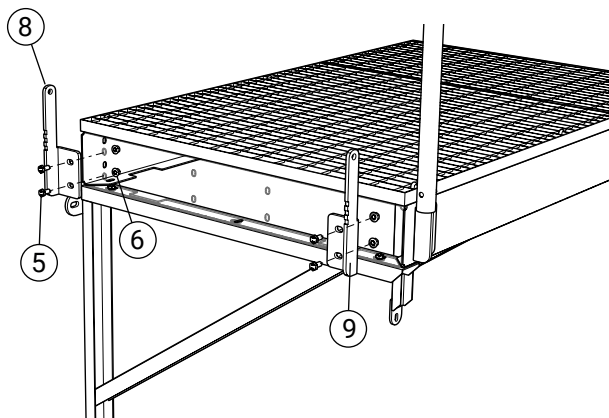

### 3. Installation of side brackets

Screw the right and left side brackets (8,9) using 2 bolts (5) + nuts (6) per bracket.

**NB** Keep an eye on the right / left side

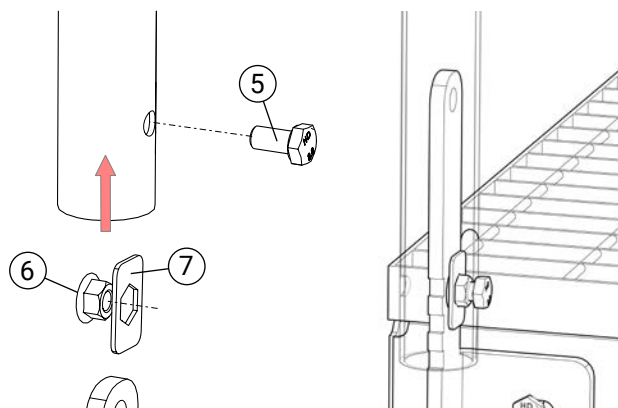

### 4. Installation of railing lock

Fit a nut (6) + lock washer (7) on a railing lock. Insert the railing tube and fit a bolt (5).

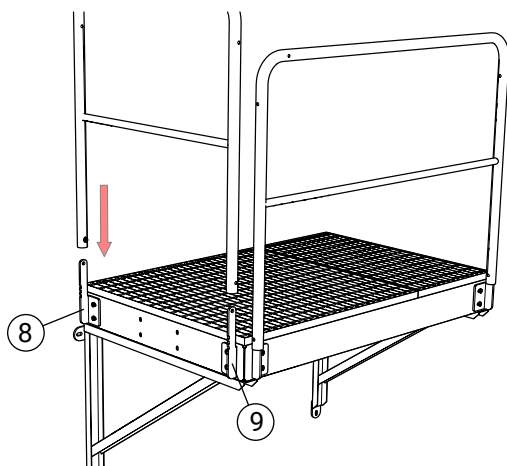

### 5. Installation of railing

Thread the railing on the right and left side brackets (8,9). Lock securely by tightening the bolt.

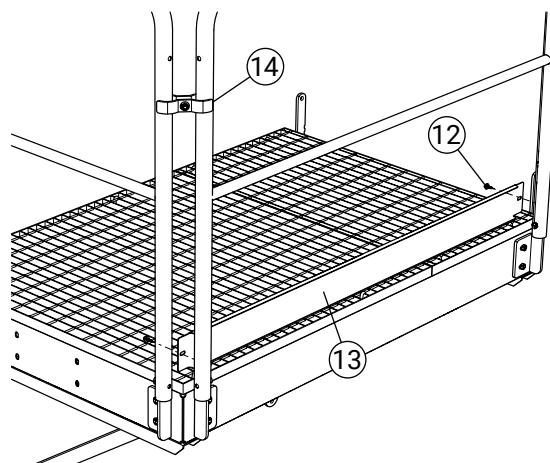

### 6. Installation of kick strip

Any kick strip (13) is to be fitted using 2 self-tapping screws (12). Connect railings with Gull wing coupling (14).

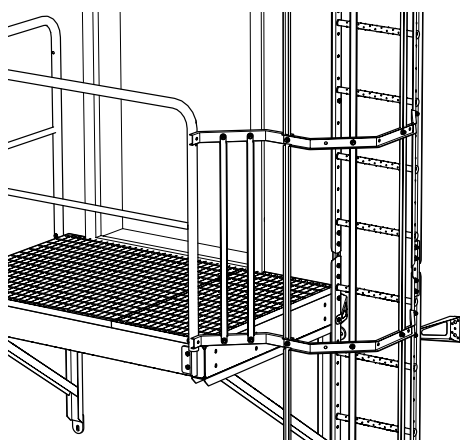

### 7. Connection to ladder

When connecting to a platform, the guard frame is to be adjusted so that the back frame is connected to the railing.