

	Part	Part. no.
1	Standing seam mount	FF0174
2	Standing seam support	FS2020
3	Bracket 5 Low	NS5150
4	Gangway mount	ÖB3000

	Part	Part. no.
5	Bolt set	BU1201
6	Set of nuts	MU1001
7	Profile grating	PBxxxx

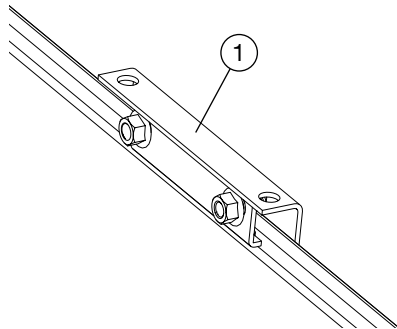

Standing seam mount

The hooks have to be mounted on the seam side.
Tighten to <math><40\text{N}</math> / bolt.

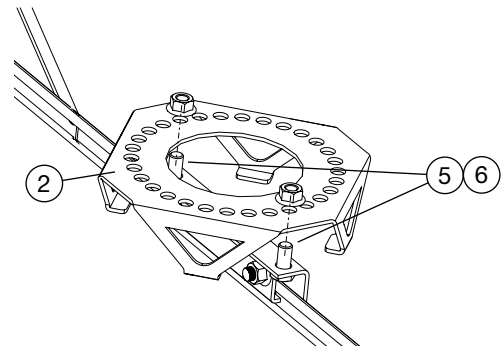

Standing seam support

Fit the standing seam support using 2 bolts + nuts (5,6) in the holes placed along the centre line.

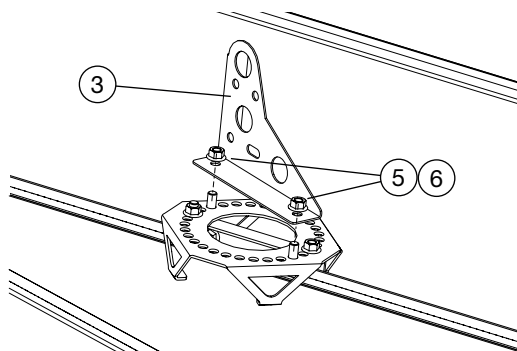

Bracket

Assemble the bracket in the holes that provide the best fit in order to get it parallel with the other brackets using 2 bolts + nuts (5,6).

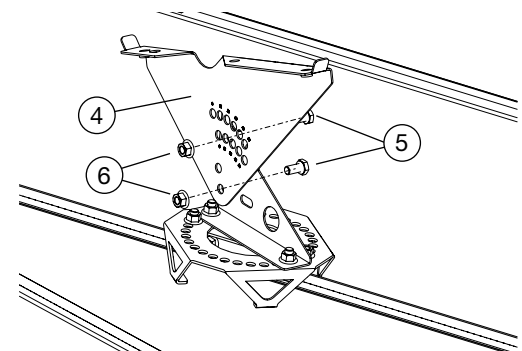

Gangway mount

Adjust the top section of gangway mounts (4), based on the roof gradient, to the horizontal position ($\pm 2^\circ$) and lock in place with 2 M10x20 bolts + nuts (5,6).

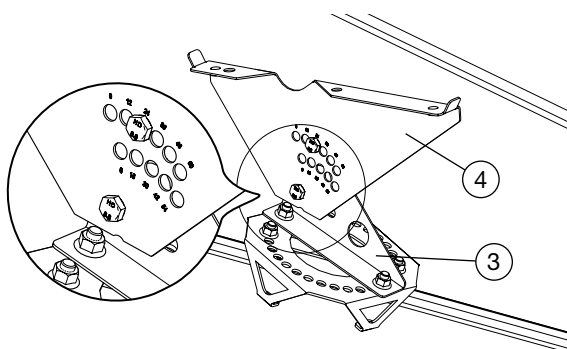

Gangway mount

For assembly in the upper holes, the bottom edge must be cut off (4).

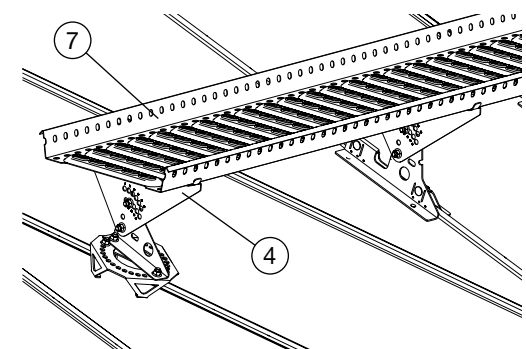

The profile grating

Fit to the top section of the gangway mount (4) using 2 M10x20 bolts (5). **Max. overhang: 300 mm.**